

date:	dealer name:	dealer city & state:	SPECIFICATION SHEET  Custom European Cabinetry by Bayer Interior Woods
job name:	room name(s):	job site delivery:	
		<input type="checkbox"/> YES <input type="checkbox"/> NO	

cabinet exterior species:	drawer front design:	"Design a Door" specifications:											
<input type="checkbox"/> Red Oak <input type="checkbox"/> Poplar <input type="checkbox"/> Birch <input type="checkbox"/> Alder <input type="checkbox"/> Cherry <i>Species Grade Options:</i> <input type="checkbox"/> Knotty <input type="checkbox"/> Rustic	<input type="checkbox"/> Hickory <input type="checkbox"/> Maple <input type="checkbox"/> Euro Beech <input type="checkbox"/> Pine <input type="checkbox"/> Paint (birch/mdf) <input type="checkbox"/> Red Birch <input type="checkbox"/> Red Birch Blend	5-Piece (DF5)		door desgin		inside profile	panel profile	outside profile	mitre profile	applied moulding	custom size stile & rail		
		5-Piece (DF5) with 1-1/2" rails		base									
		1-Piece Solid Slab (DF1S)		upper									
		1-Piece Veneer Slab (DF1V)											
				drawer box construction-material:		cabinet finish side type:		drawer front profiles if different than door					
		Dowelled - 5/8" White "Thermo" Melamine		CAIT-10-FE		CAIT-14-FE							
		Dowelled - 5/8" Maple "Thermo" Melamine		CAIT-12-FE									
		Dovetail - 5/8" Solid White Hardwood		cabinet modifications, accessories & mouldings:									
		Dovetail - 5/8" Solid ASPEN											
finish color:	drawer guide type:			qty	sku # or description			cabinet					
<input type="checkbox"/> Standard <input type="checkbox"/> Premium <input type="checkbox"/> Color Match	<input type="checkbox"/> Choice <input type="checkbox"/> Unfinished	3/4 EXTENSION - Self Close - side mount											
		FULL EXTENSION - Soft Close - under mount											
		moulding:											
Color name / #:		qty	8ft pc/LF	sku # / description									
finish options:					crown/cove								
<input type="checkbox"/> Glaze color: _____					crown/cove								
<input type="checkbox"/> Distressing - fill out additional form					MB 58-13 build-up for crown								
cabinet interior material:					BA200 base shoe								
<input type="checkbox"/> White "Thermo - Fused" Melamine					island base shoe								
<input type="checkbox"/> Maple "Thermo - Fused" Melamine					island base								
<input type="checkbox"/> All Veneer Plywood					OC652 90° outside corner								
*finished sides may be two sided veneer					OC653 135° outside corner								
					TKS8 toekick skin								
cabinet style / design:					1" top scribe strip								
Door Design:					other:								

CABINET FINISHED SIDE TYPES:

CABINET FINISHED BACK TYPES:

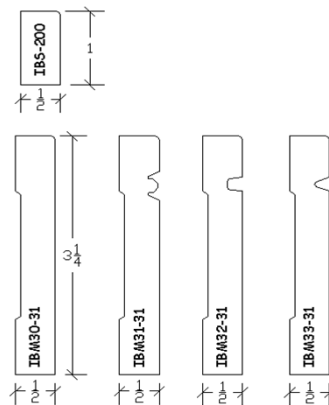
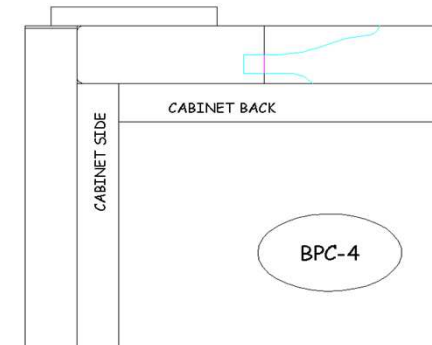
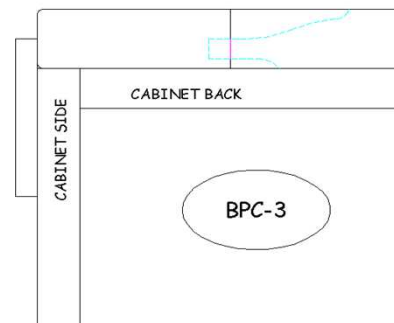
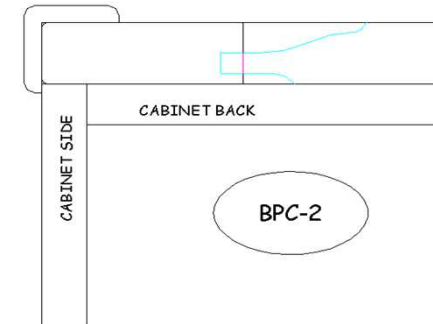
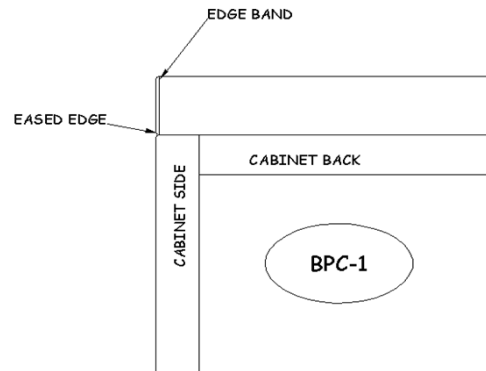
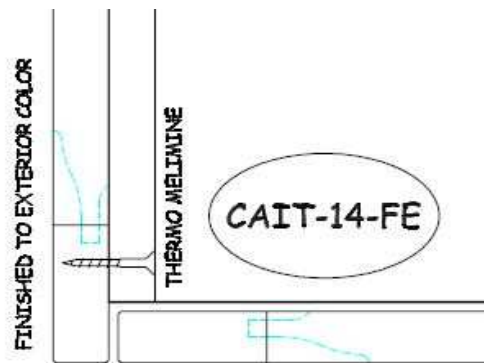
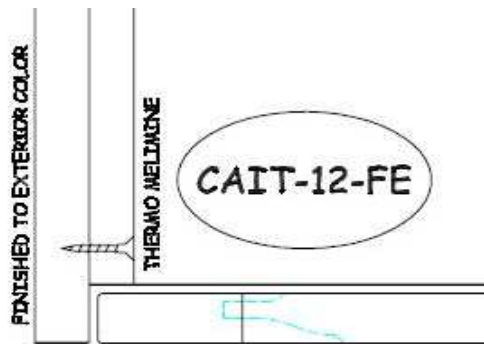
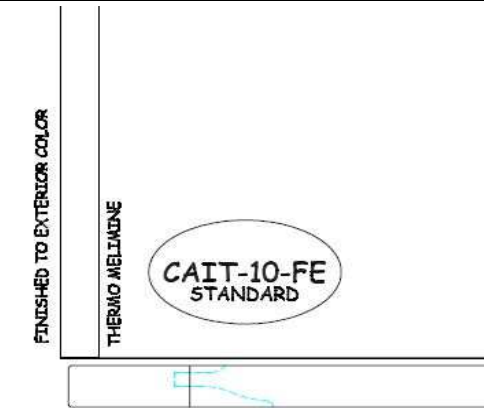

**ISLAND
BASE SHOE**

**ISLAND
BASE
MOULDING**

**** WITH ALL SELECTIONS MADE PLEASE
NOTE THIS TO YOUR DESIGNER WHEN
SENDING A QUOTATION REQUEST****

